



BRAND Hadco by Signify

DESCRIPTION

RRCL14 Round Louver Steplyte features a thermoset polyester powdercoat finish available in Black, White or Bronze. A High performance aluminum reflector for optimum symmetrical light output. Horizontal Louver lens made of die-cast aluminum with a 45 degree cut-off and frosted tempered glass. Die-cast aluminum back box housing. A Fixture is pre-wired with 6 foot pigtail of 18-2 AWG wire. A Includes low voltage quick connector LVC3 for easy hook-up to the low voltage supply cable not included. Thermal protection device, not included, is required for installations in drywall, plaster, wood or other non-masonry materials. A ncludes one 10 watt T3 bipin halogen lamp. A Lower wattage lamps are acceptable. A 4 inch diameter x 3.6 inch deep housing. A ETL listed for wet locations. Requires remote transformer not included.



SHADE COLOR	Frosted
BODY FINISH	Bronze
WATTAGE	10W
DIMMER	Dimmable
DIMENSIONS	4"W x 4"H x 3.6"D
BULB INCLUDED	
LAMP	1 x T3/Bipin/10W/12V Halogen
SPEC #	HAD120424

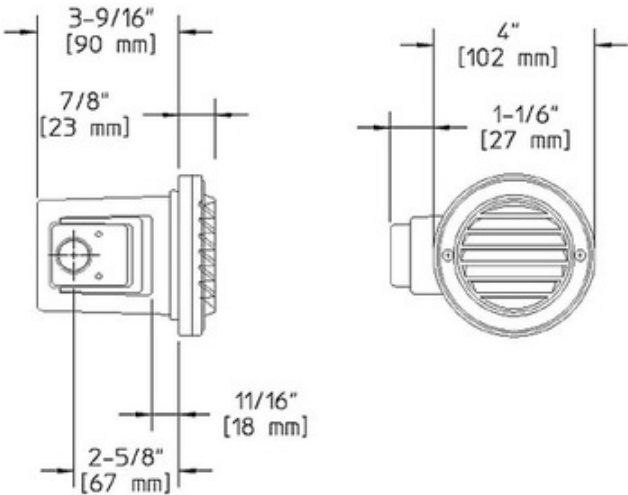

COMPANY	PROJECT	FIXTURE TYPE	APPROVED BY	DATE