



BRAND Hadco by Signify

DESCRIPTION

1012 Beacon features a one piece injection molded polyester resin housing with removable roof for easy relamping. Molded silicone gasket seals glass, top and bottom, and prevents moisture intrusion into the fixture. Base has two .5 inch NPT conduit entrances for connection to the power source. Composite is textured, pressure formed in Bronze finish. Clear borosilicate glass refractor lens. One 100 watt 120 volt A-type medium base lamp is required, but not included. 8.4 inch diameter x 12.25 inches high. ETL listed for wet locations.



SHADE COLOR	N/A
BODY FINISH	Bronze
WATTAGE	72W
DIMMER	Standard 120V
DIMENSIONS	8.4"W x 12.25"H
BULB NOT INCLUDED	
LAMP	1 x A19/Medium (E26)/72W/120V Incandescent 1 x A19/Medium (E26)/120V LED

SPEC # HAD21562

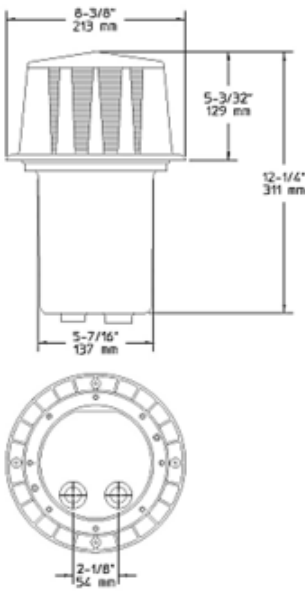

COMPANY	PROJECT	FIXTURE TYPE	APPROVED BY	DATE