



BRAND Juno Lighting

DESCRIPTION

R701 Cylinder MR16 Low Voltage Track Fixture features a 90 degree vertical aiming capability and 358 degree rotation. Polycarbonate transformer housing with a painted formed steel lamp housing with finish in Black or White. Copper alloy contacts provide precise spring action. True, positive electrical ground. On/off switch included. 50 watt 12 volt electronic transformer with circuit protection included. Patented embossed polarity arrows on bottom of adapter. Spring-loaded locking latch with embossed polarity arrows secures fixture to the track. Pull-up contact to up position for use on two-circuit track. One 50 watt, 12 volt GU5.3 MR16 halogen bulb or LED equivalent is required, but not included. Halogen dimmable with an electronic low voltage dimmer. Consult bulb manufacturer for dimmer compatibility when using LED equivalent. 2.25 inch diameter x 3.25 inch height x 5.5 inch length. UL listed. Compatible with Juno Lighting Trac-Lites 1-circuit and Trac-Master 1-circuit and 2-circuit 120 volt line voltage track systems.



SHADE COLOR	N/A
BODY FINISH	Black
WATTAGE	50W
DIMMER	Low Voltage Electronic
DIMENSIONS	5.5"L x 2.25"W x 3.25"H
BULB NOT INCLUDED	
LAMP	1 x MR16/GU5.3 (bipin)/50W/12V Halogen 1 x MR16/GU5.3 (bipin)/12V LED
SPEC #	JUN25981

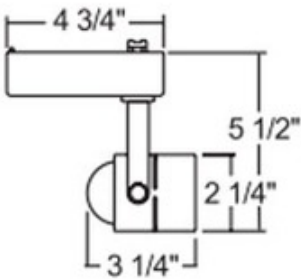

COMPANY	PROJECT	FIXTURE TYPE	APPROVED BY	DATE