

## Installation Instructions for TruLine .5 24VDC for Drywall using Screws

### IMPORTANT INFORMATION

- This fixture is wall or ceiling mount.
- This instruction shows a typical installation.

**SAVE THESE INSTRUCTIONS!**

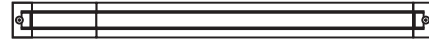

### Install the Junction Boxes

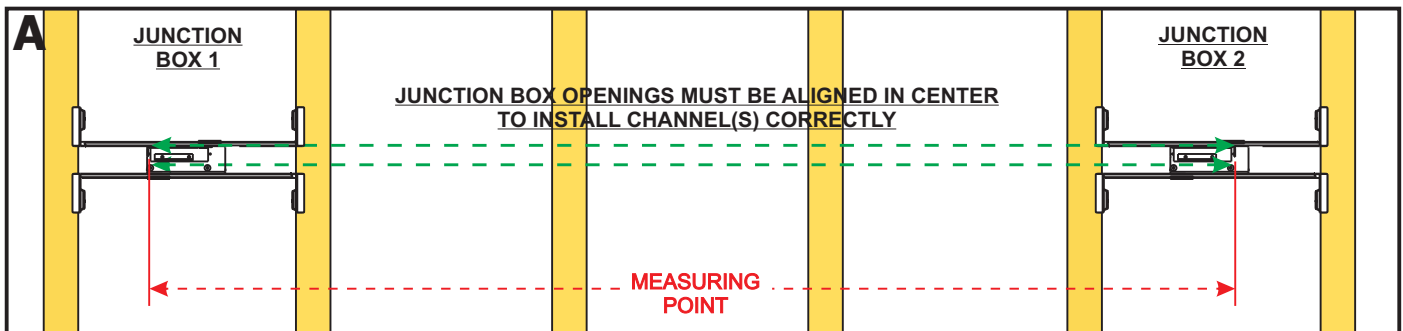

**NOTE:** Select the location between the two studs where the channel is going to be mounted. Each end of the channel must be into a junction box opening. One junction box is used as the power feed and the other one for excess soft strip.

**NOTE:** Channel may be cuttable in the field.

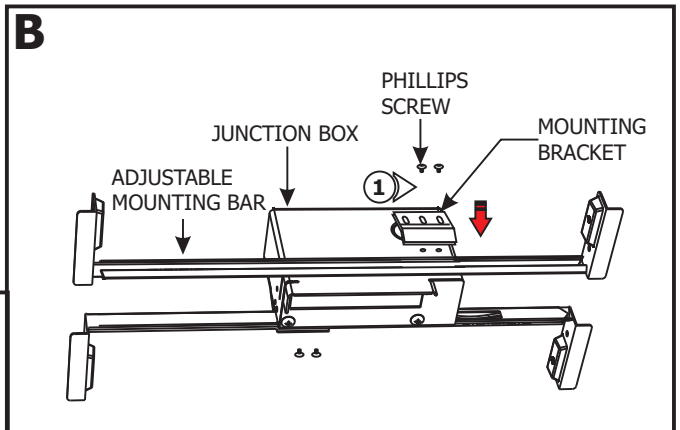

- 1:** Mount each adjustable mounting bar to one side of the junction box (mounts to any side of the housing depending on the orientation of the channel) and secure them with the mounting brackets two Phillips screws provided.

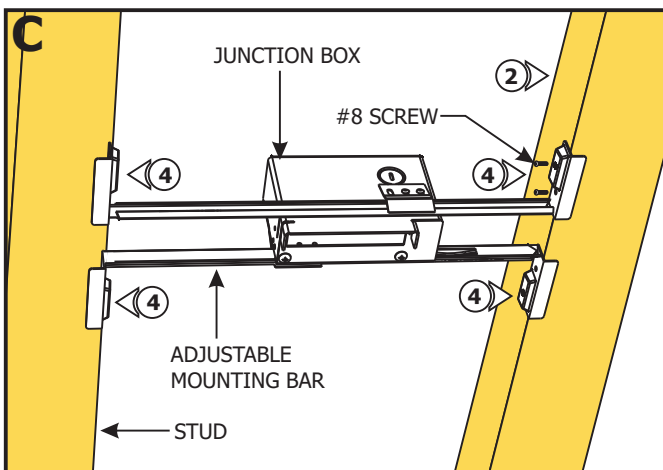

**NOTE:** The adjustable mounting bars mount to studs that are spaced 16" to 24" apart.

- 2:** Select the location between the two studs for the junction box to be mounted.
- 3:** Place the adjustable mounting bars between the studs.
- 4:** Make sure the lips on the adjustable mounting bars are against the studs. Secure the adjustable bars to the studs with the eight #8 screws.

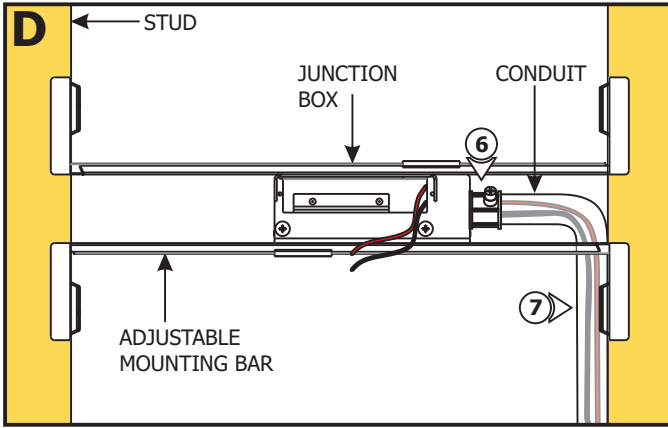

**5:** Remove a knockout to install the power line conduit.

**6:** Install the conduit and run the low voltage 24V DC power line wires coming from the remote power supply to the junction box.

**7:** Refer to the instruction provided with the power supply to properly wiring diagram.

**8:** Mark a 4" x 1-1/8" rectangle to the drywall where each junction box opening will be located.

**9:** Cut out the marked square(s) and install the drywall.

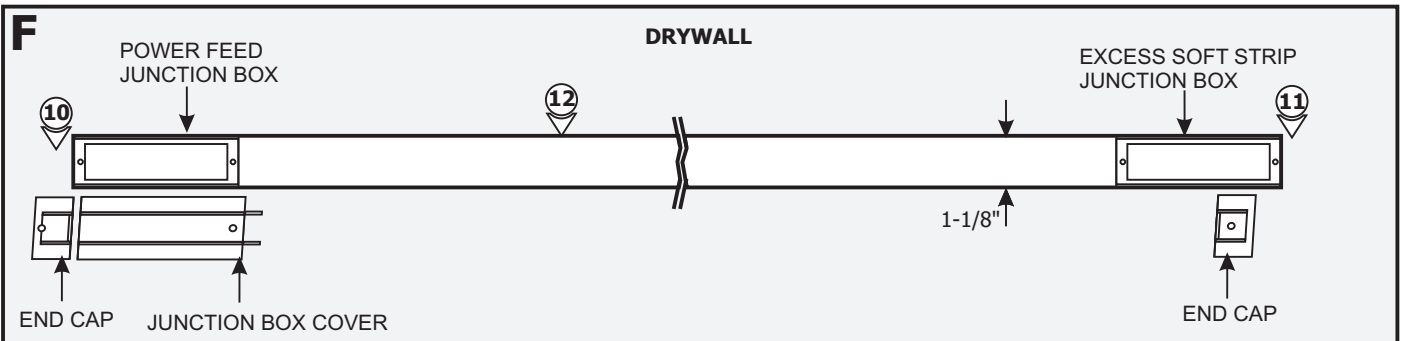
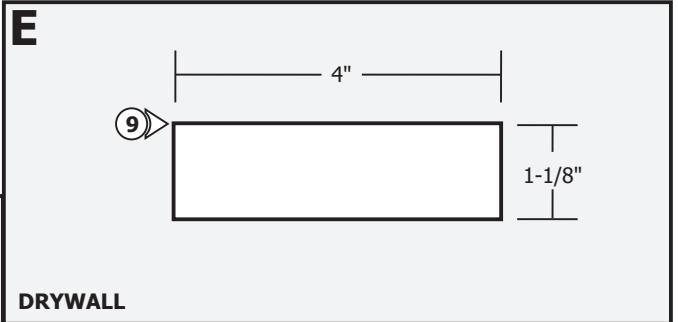

**10: For the Power Feed Junction Box:** Secure the end cap & junction box cover with the 4-40 screw, and make any reference marks that are needed.

**11: For the Excess Soft Strip Junction Box:** Secure the end cap to the junction box with the 4-40 screw, and make any reference marks that are needed.

**12:** Cut out the drywall between the junction boxes for the channel to be installed to.

**13:** Remove the end cap of the power feed junction box, leave the junction box cover secured.

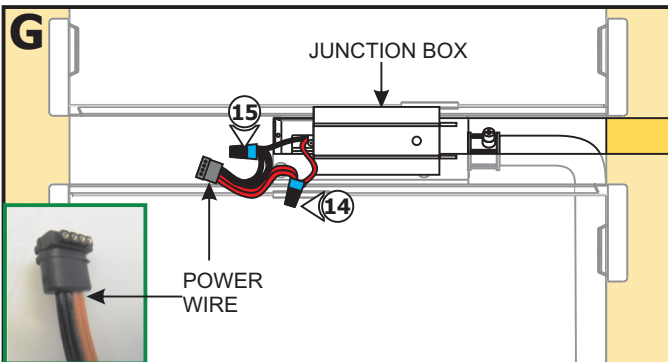

**14:** Connect the red power supply (24VDC+) wires to power wire red strip wire with a wire nut inside the electrical box.

**15:** Connect the black power supply (24VDC-) wires to black strip wire with a wire nut inside the electrical box.

**16:** Place the wire nut connections inside junction box.

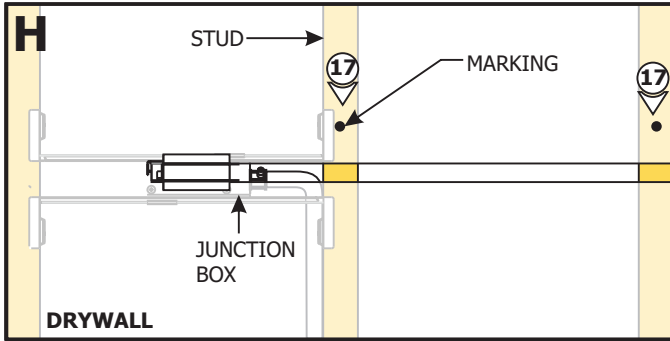

**17:** Mark the location to the studs, for future reference.

**18:** Insert the channel into the channel cover ends and carefully insert into the drywall slot.

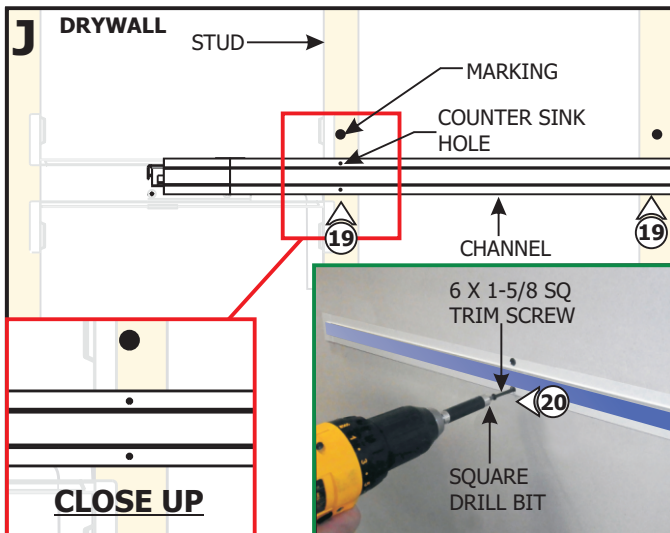
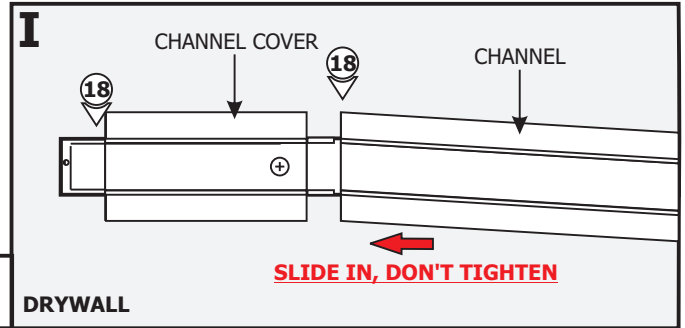

**19:** Using the mark locations on the drywall, carefully make a hole to each side of the channel using the square drill bit with counter sink provided.

**20:** Secure the channel to the wall using the #6 X 1-5/8" square trim screw with the square recess bit provided.

**NOTE:** Make sure screw head is flush with the channel.

**NOTE:** Test the product, before any plaster work is done.

**NOTE:** If plastering, make sure that the lens is installed in the channel and the blue tape is not removed to protect the channel.

**21:** Use a 12" compound knife for a smooth compound spread. Sand and finish the drywall before removing the lens.

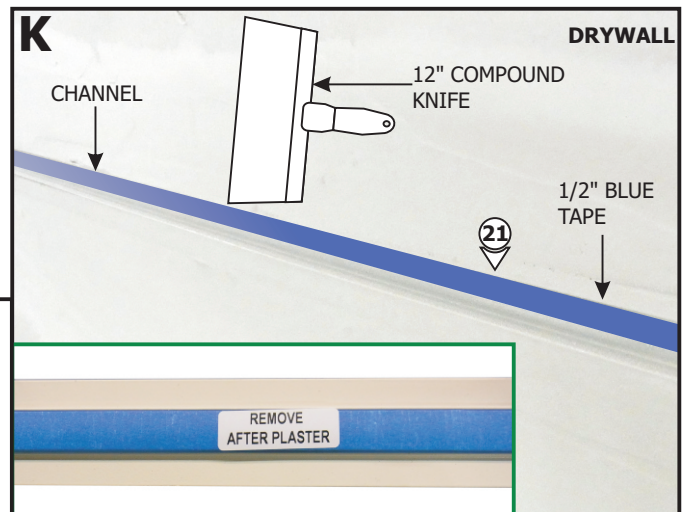

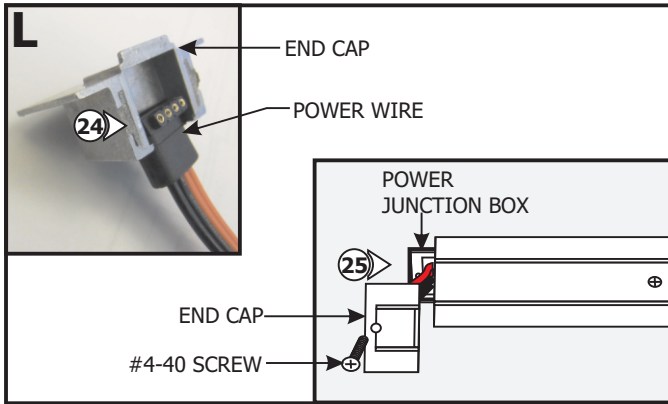

**22:** Remove lens from the channel.

**23:** Clean the area inside the channel where the soft strip LED will be installed.

**24:** Push the power wire into the end cap.

**25:** Secure end cap using the #4-40 screw to the power junction box.

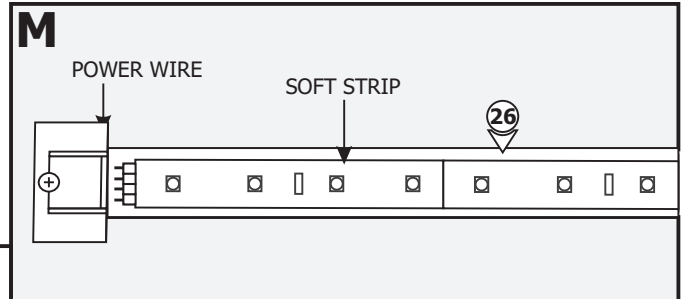

**26:** Push the soft strip male end onto the soft strip power wire.

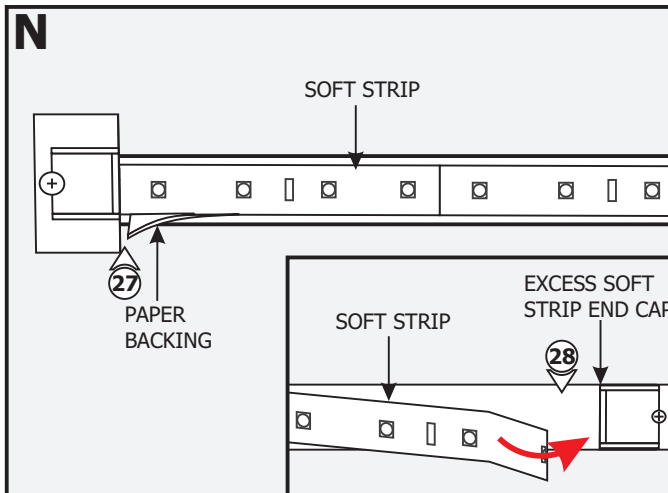

**27:** Carefully remove the backing from the LED soft strip, make sure not to remove the tape from the soft strip. Firmly press down the adhesive portion of the soft strip onto the channel surface while removing the rest of the backing, making sure there are no air bubbles that can cause surface irregularities.

**28: OPTIONAL:** Trim the soft strip on the dashed cuttable section, place the excess soft strip inside the junction box.

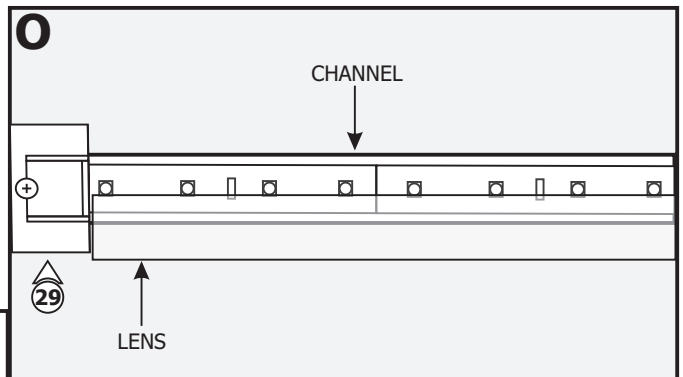

**29:** Remove the tape from the lens and snap lens into the channel.

### GENERAL WIRING DIAGRAM

