

Pure
LIGHTING

© 2013 Pure Lighting. All Rights Reserved.

Installation Instructions For True Line 1.6 24VDC

1718 W. Fullerton Ave
Chicago, IL 60614
Tel: 773-770-1195
Fax: 773-935-5613
www.purelighting.com
info@purelighting.com

IMPORTANT INFORMATION

- This fixture is wall or ceiling mount.
- This instruction shows a typical installation.
- For Corner Installation Instructions, see Section Two on page 5.

SAVE THESE INSTRUCTIONS!

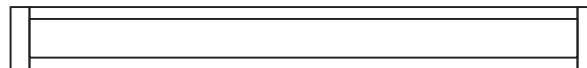

Section One: Standard Installation

Install the Channel

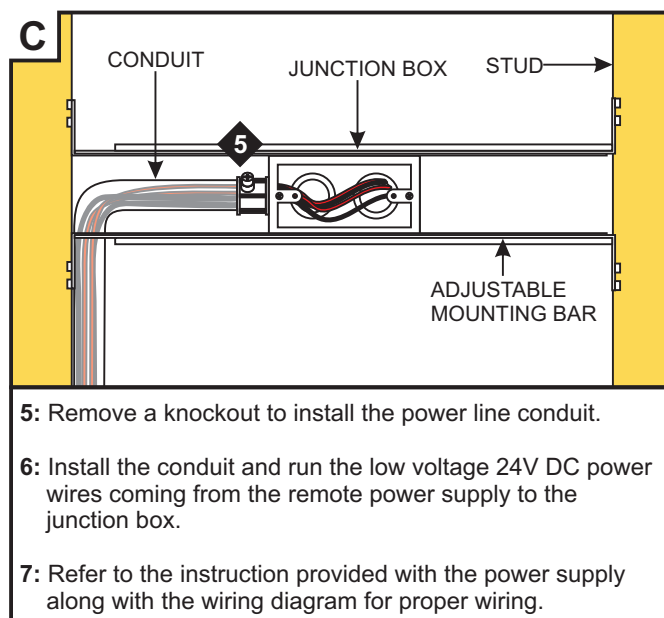
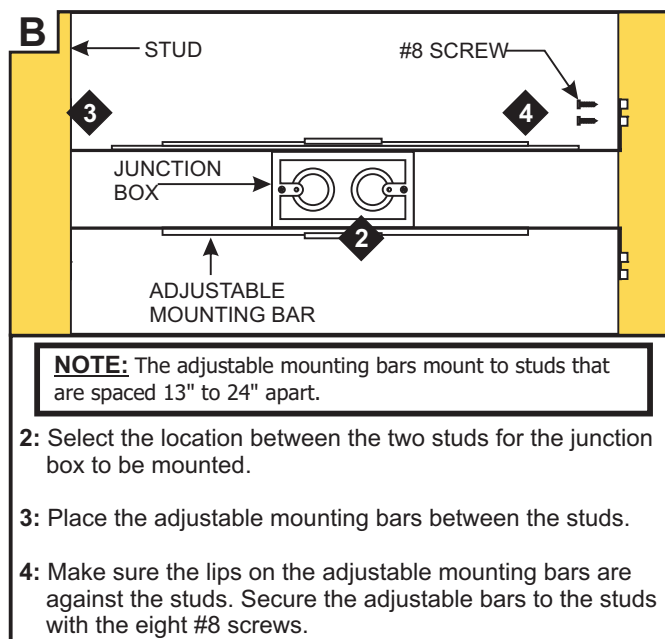
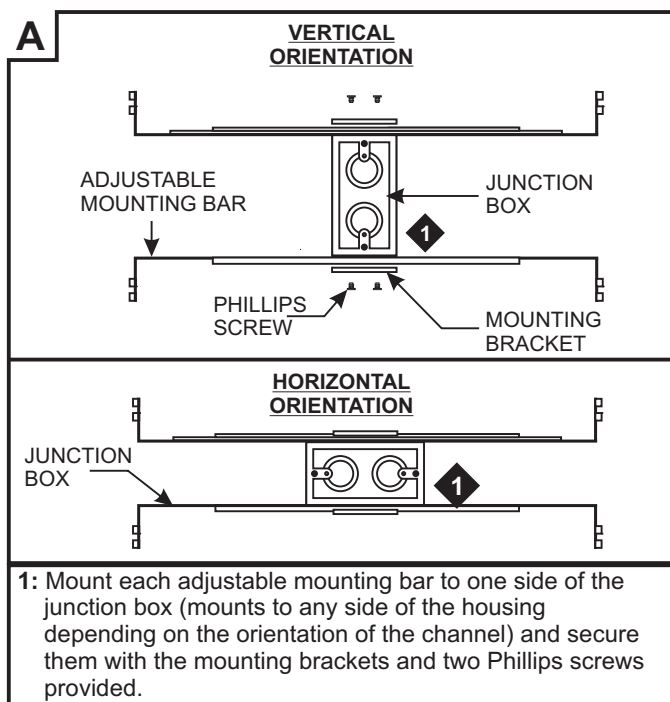

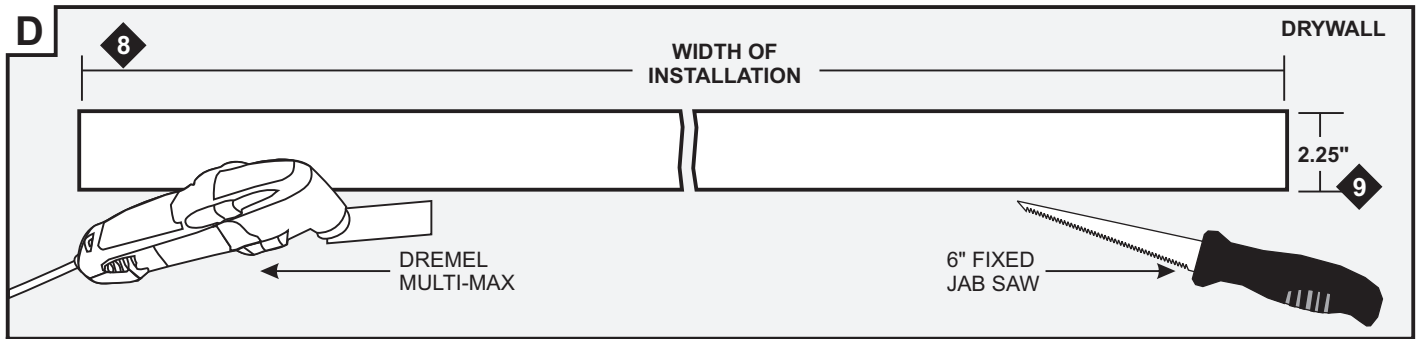

8: Mark the area where the channel will be located on the drywall.

9: Cut out the marked area(s) and install the drywall, using a "Dremel Multi-Max" with the "wood & drywall" cutting bit or a 6" Fixed Jab Saw.

10: Install & finish drywall.

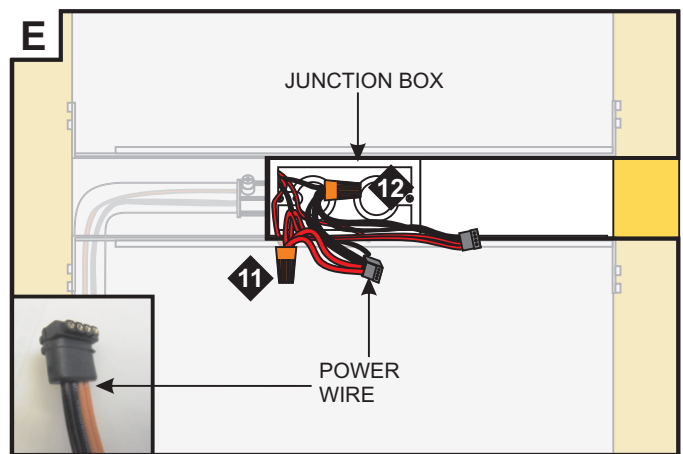

11: Connect the red power supply (24VDC+) wires to each red power wire with a wire nut inside the junction box.

12: Connect the black power supply (24VDC-) wires to each black power wire with a wire nut inside the junction box.

13: Place the wire nut connections inside junction box.

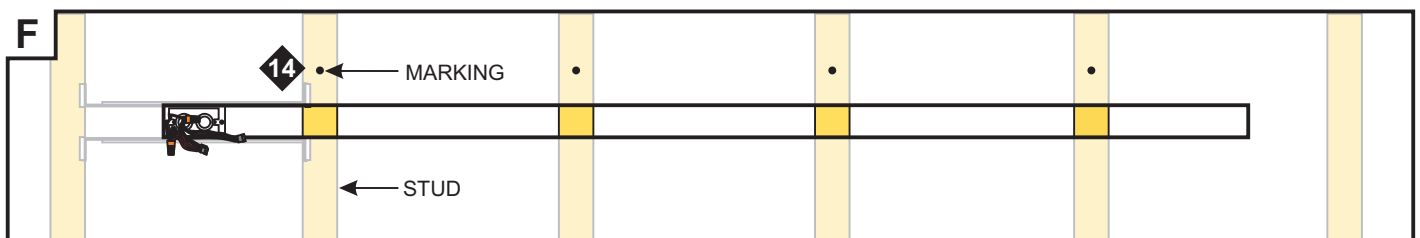

14: Mark the location of the studs to the drywall for future reference.

NOTE: If channel is to be installed in a wall without standard-spaced studs, refer to Section Three on Page 10.

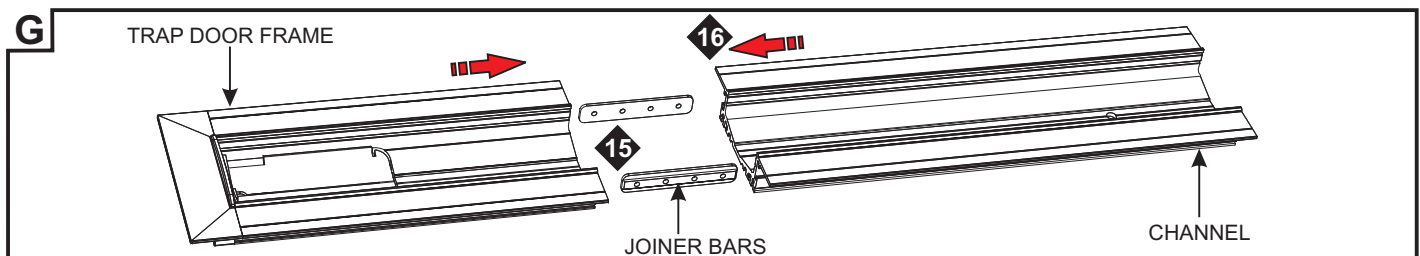

15: Insert the joiner bars halfway into the channel trap door frame. Tighten the two #4-40 set screws on each joiner bar with a 0.05" Allen wrench.

16: Slide the other section of channel onto the joining bars and tighten the remaining #4-40 set screws with a 0.05" Allen wrench.

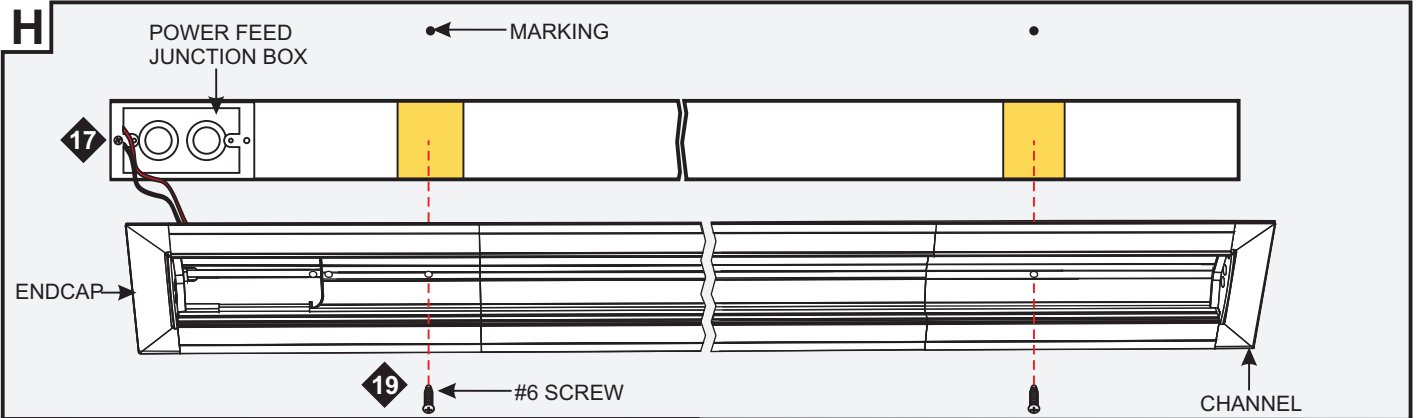

17: Insert the power wires into the channel end cap.

18: Using the mark locations on the drywall, carefully make a hole to channel using the provided square drill with counter sink bit.

19: Secure the channel to the stud with the #6 screws using the provided square recess bit.

NOTE: If channel does not line up with a stud, use the provided constraint clip kit to install to the drywall. Refer to diagram to the right for reference. For alternate installation, refer to Section Three on Page 10.

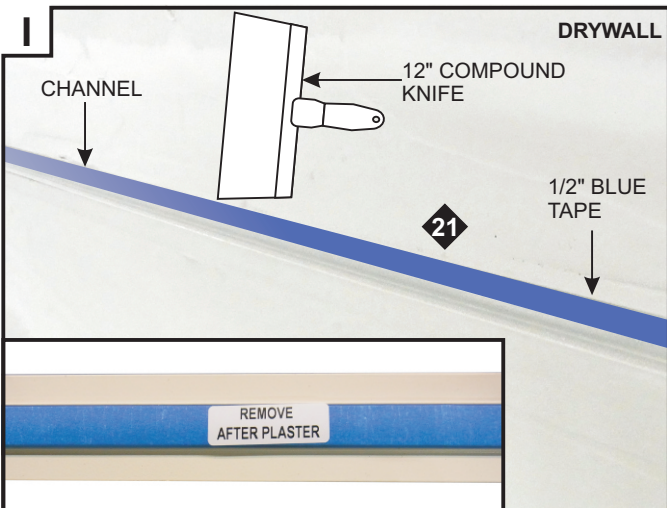
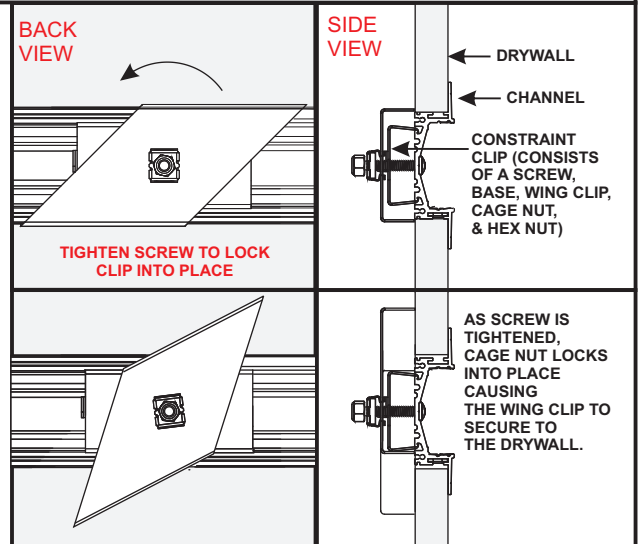

NOTE: Test the product, before any plaster work is done.

NOTE: Make sure that the lens is installed in the channel and add blue tape to the lens to protect the channel from debris.

21: Use a 12" compound knife for a smooth compound spread. Sand and finish the drywall before removing the lens.

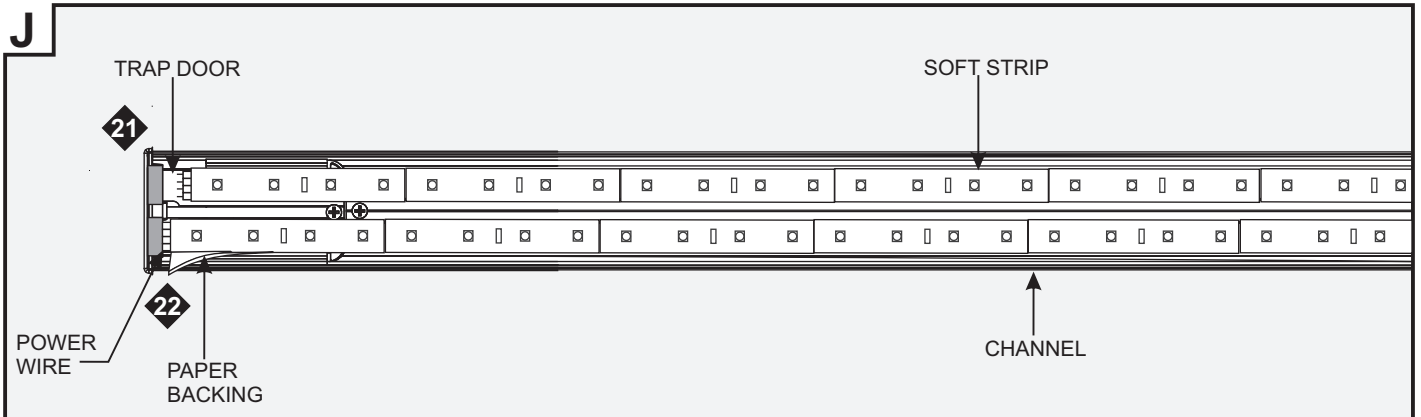

22: Line up the red wire side of the power connector with the "+24VDC" marking on the Soft Strip. Push the male connector of the Soft Strip into the female connector of the power cables.

23: Carefully remove the backing from the LED soft strip, make sure not to remove the tape from the soft strip. Firmly press down the adhesive portion of the soft strip onto the channel surface while removing the rest of the backing, making sure there are no air bubbles that can cause surface irregularities.

24: Trim the soft strip on the dashed cuttable section, place the excess soft strip inside the other junction box, which does not contain power wires. Ensure the entire length of the channel is covered with Soft Strip to avoid unlit areas.

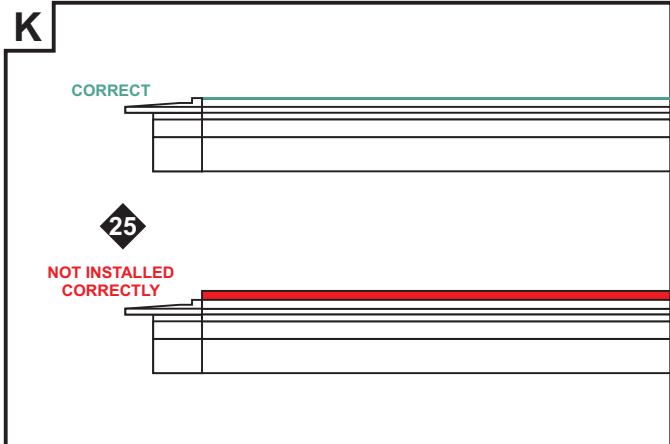

25: Snap the lens back onto the channel.

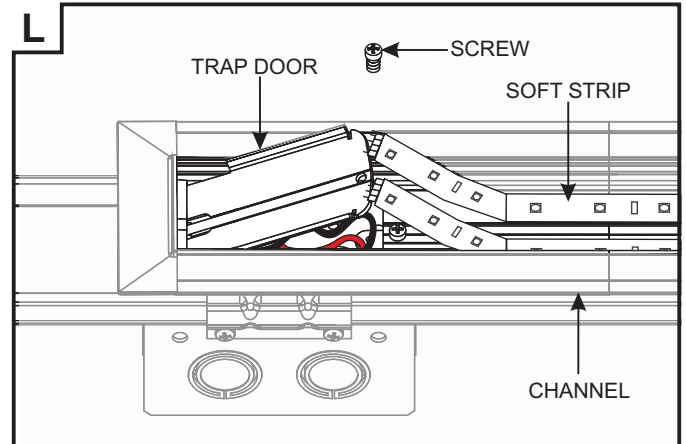

NOTE: If necessary access the wire connections by opening the trap door. Disconnect the soft strip and remove screw on the trap door. Pull open the trap door to expose the wiring.

Section Two: Corner Installation

NOTE: One junction box is required for each run of channel that will end in a mitered corner.

IMPORTANT: The soft strip used in 90° corner installations will be installed from the miter cut points. Both electrical boxes will need power connections.

REFER TO STEPS 1 THROUGH 8 ON PAGE 1 FOR JUNCTION BOX INSTALLATION INSTRUCTIONS

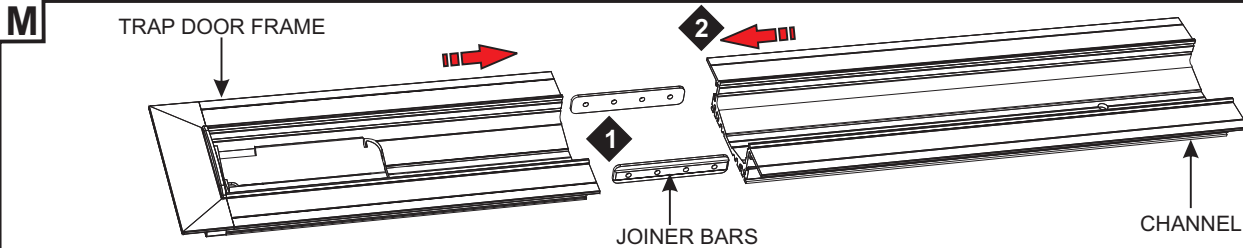

- 1: Insert the joiner bars halfway into the channel trap door frame. Tighten the two #4-40 set screws on each joiner bar with a 0.05" Allen wrench.
- 2: Slide the other section of channel onto the joining bars and tighten the remaining #4-40 set screws with a 0.05" Allen wrench.

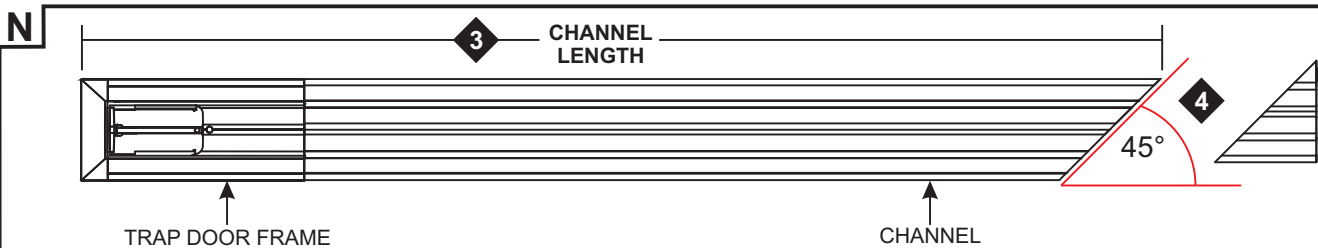

- 3: Determine the proper channel length and cut channel end at a 45° angle from the outer corner.
- 4: Cut additional channel assembly for the opposing 45° angle to match the height of the installation.

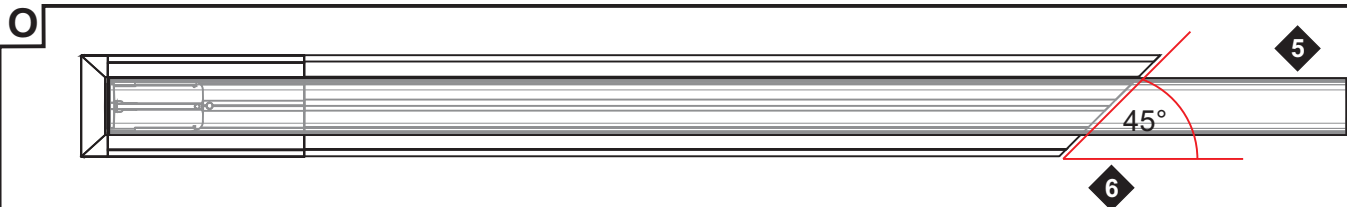

- 5: Install one length of TruLine 1.6 lens into a cut channel assembly.
- 6: Use the cut channel assembly as a template to cut the lens at a 45° angle matching the channel length. Repeat for any additional channel sections.

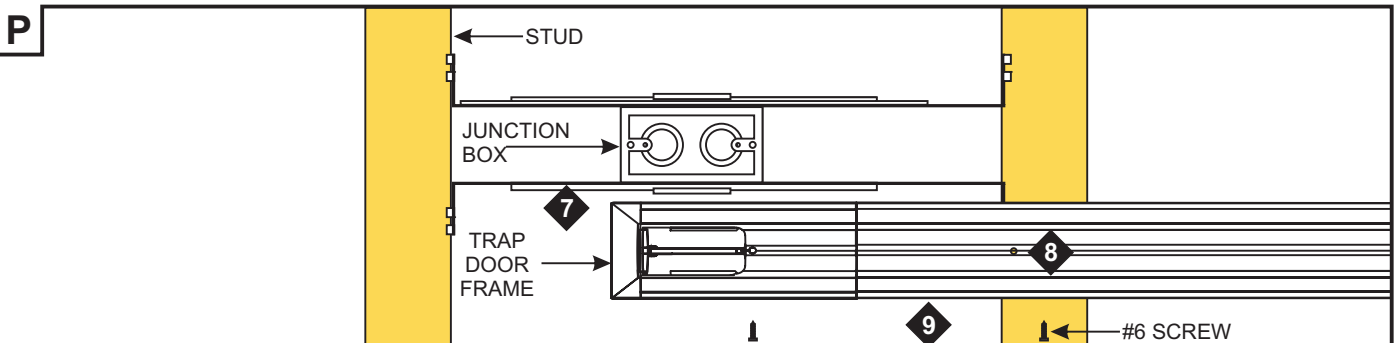

- 7: Install the trap door frame section of the channel assembly to one junction box using the two #8-32 screws provided.
- 8: Ensure the channel is level. Carefully make holes to the channel where it aligns with studs using the provided square drill with counter sink bit.
- 9: Secure the channel to the studs with the #6 screws.

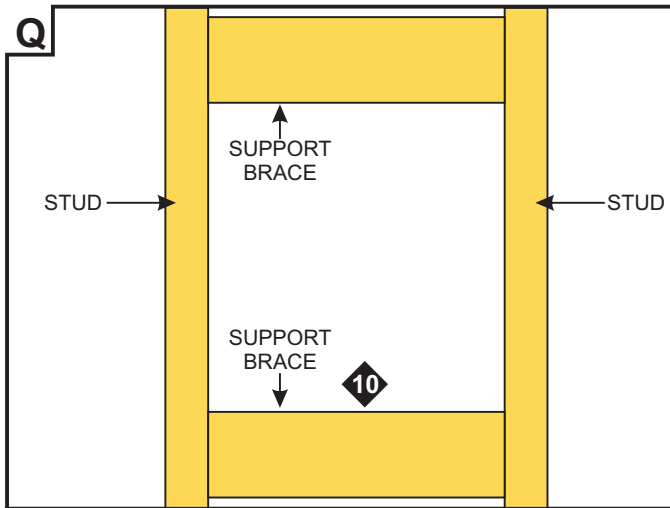

10: Cut and install 2x4 support braces between studs to support the channels as needed. Maximum recommended spacing between the support braces is 36".

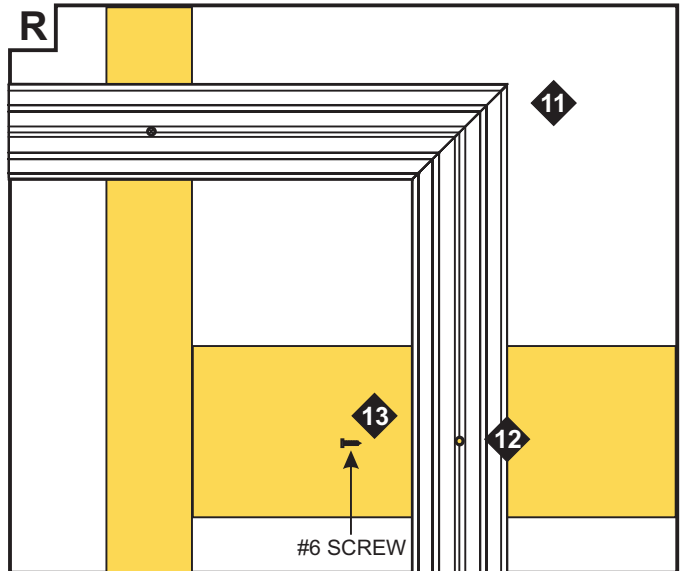

11: Align miter cut channel ends. Make sure there is no visible gap where miter corners meet.

12: Ensure both channels are leveled. Carefully make holes to the channel where it meets the support braces using the provided square drill with counter sink bit.

13: Secure the channel to the support braces with the #6 screws.

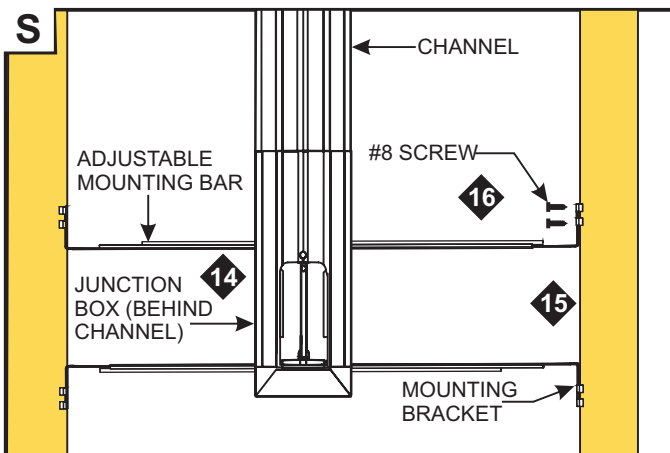

14: Align the junction box behind the mounted vertical channel section using the adjustable mounting bars and mount junction box to channel with the provided screw.

15: Place the adjustable mounting bars between the studs.

16: Make sure the lips on the adjustable mounting bars are against the studs. Secure the adjustable bars to the studs with the eight #8 screws.

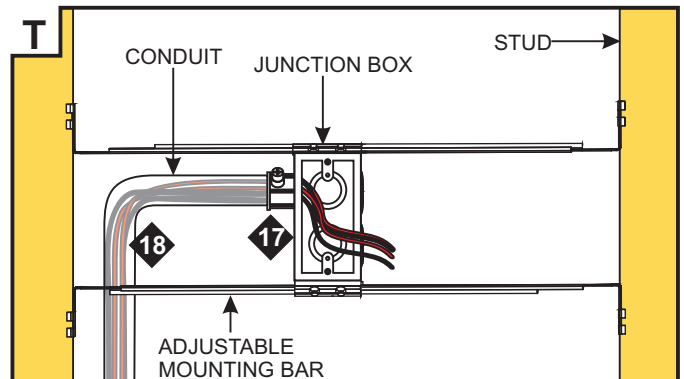

17: Remove a knockout to install the power line conduit.

18: Install the conduit and run the low voltage 24V DC power line wires coming from the remote power supply to the junction box.

19: Refer to the instruction provided with the power supply to properly connect the power.

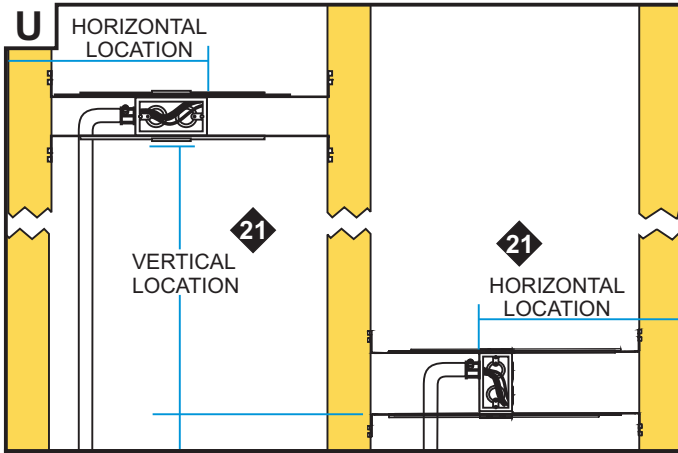

20: Loosen the screws to remove the channels.

21: Measure the horizontal and vertical locations of both junction boxes.

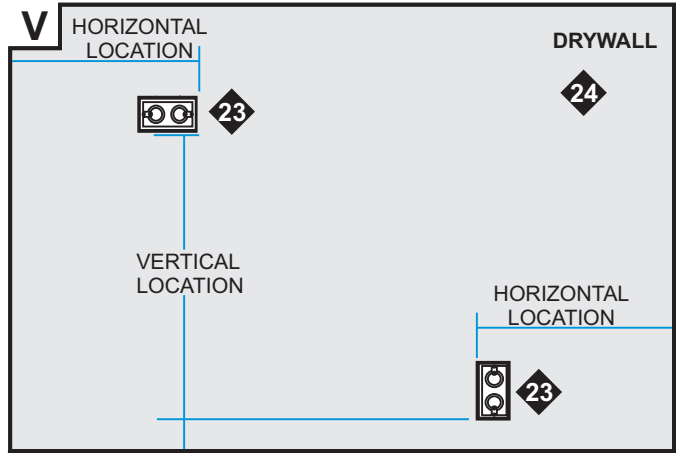

22: Mark the area where the junction boxes will be located on the drywall.

23: Cut out the marked areas to expose the junction boxes

24: Install the drywall.

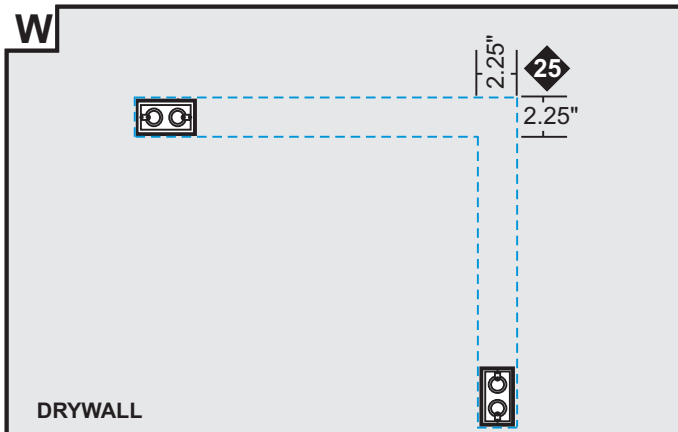

25: Mark the areas on the drywall where the channel will be installed.

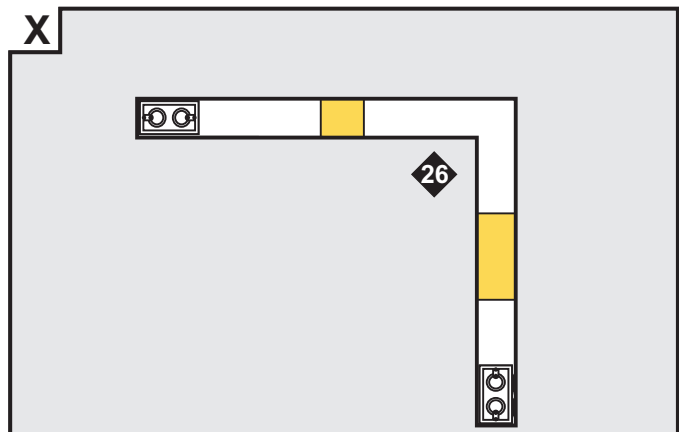

26: Cut out the marked areas of the drywall.

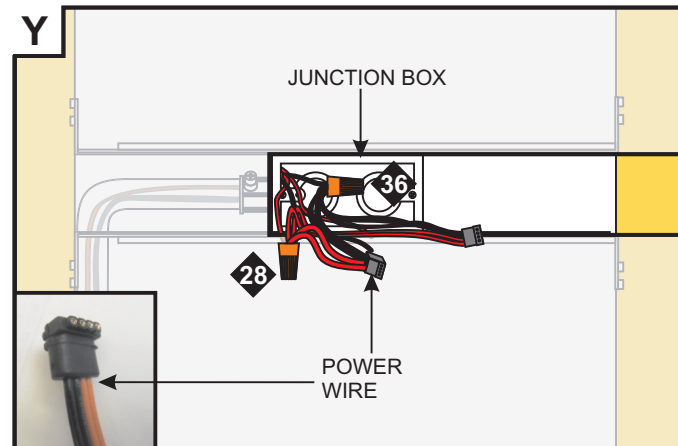

27: Connect the red power supply (24VDC+) wires to each red power wire with a wire nut inside the junction box.

28: Connect the black power supply (24VDC-) wires to each black power wire with a wire nut inside the junction box.

29: Place the wire nut connections inside junction box.

30: Repeat electrical connections for additional junction box.

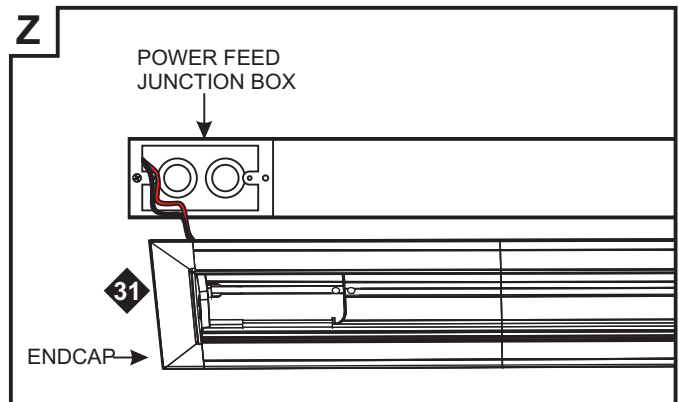

31: Insert the power wires into each channel end cap.

Z1

DRYWALL

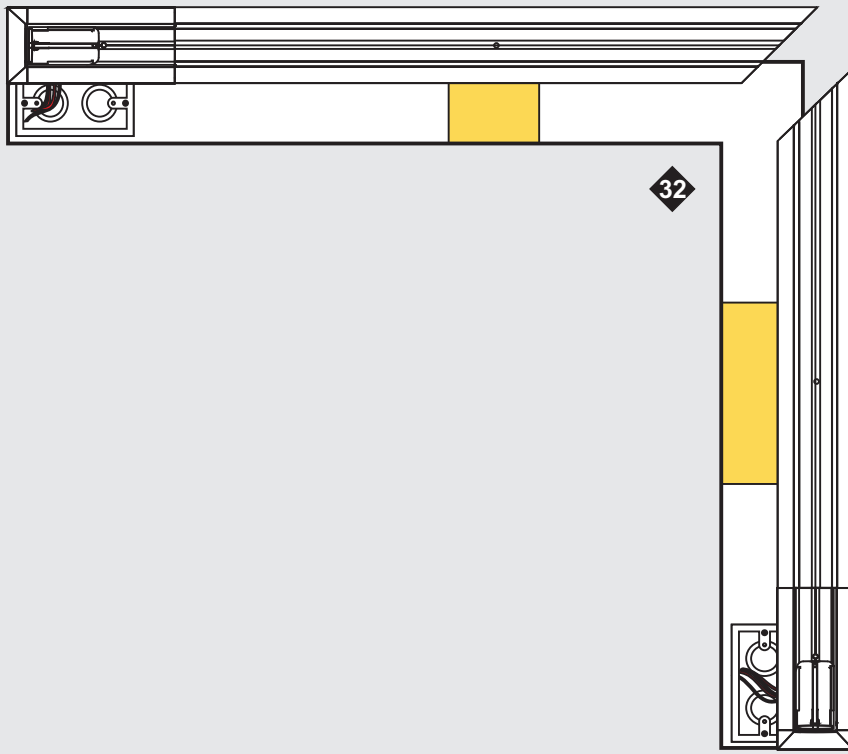

32: Reinstall both channel sections to junction boxes and studs/support braces by following Steps 8-9 on Page 5 and Steps 12-14 on Page 7.

Z2

DRYWALL

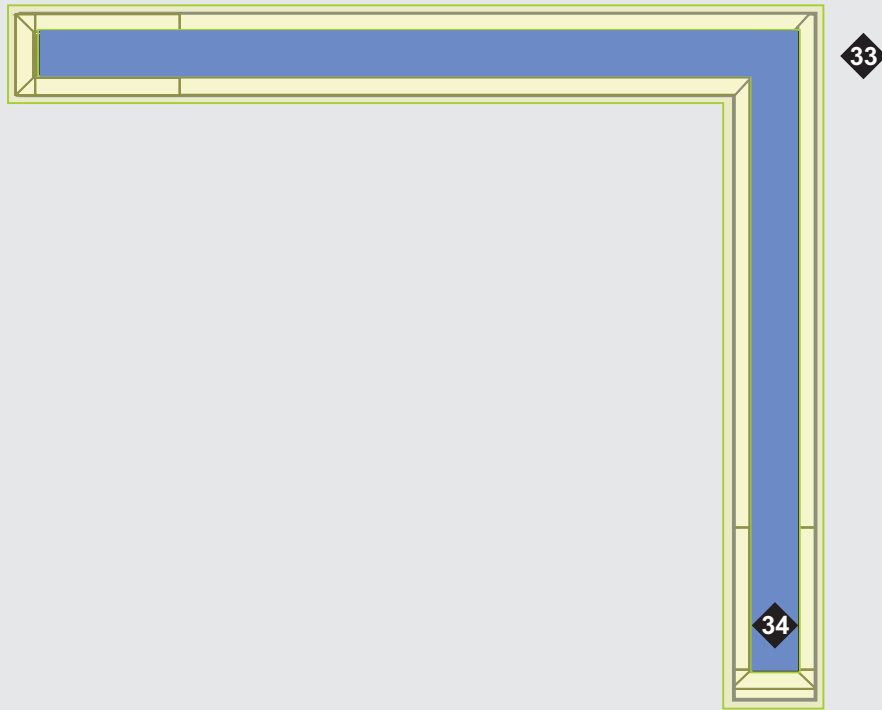

NOTE: Test the product before any plaster work is done.

NOTE: Make sure that the lens is installed in the channel and cover it with blue tape to protect the channel from any debris

33: Plaster mounted channels and end caps (highlighted in green) to the drywall. Finish the wall properly.

34: Remove the blue tape and lenses from the assembly and clean the channel.

Z3

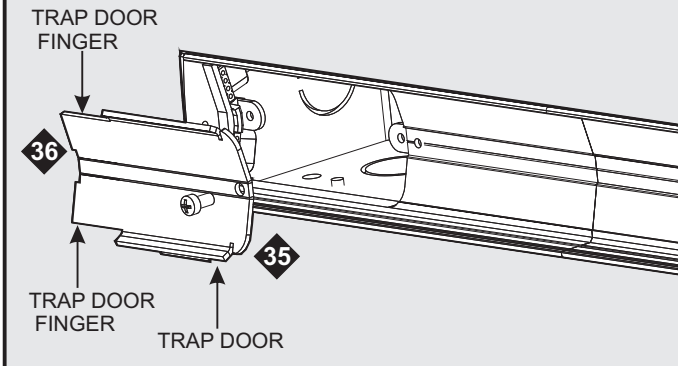

35: Remove the screw from the junction box and remove the trap door.

36: Lightly bend the two trap door fingers to ease access to the power connections.

37: Pull the power connectors from the junction box.

38: Reinstall the trap door to the junction box.

Z4

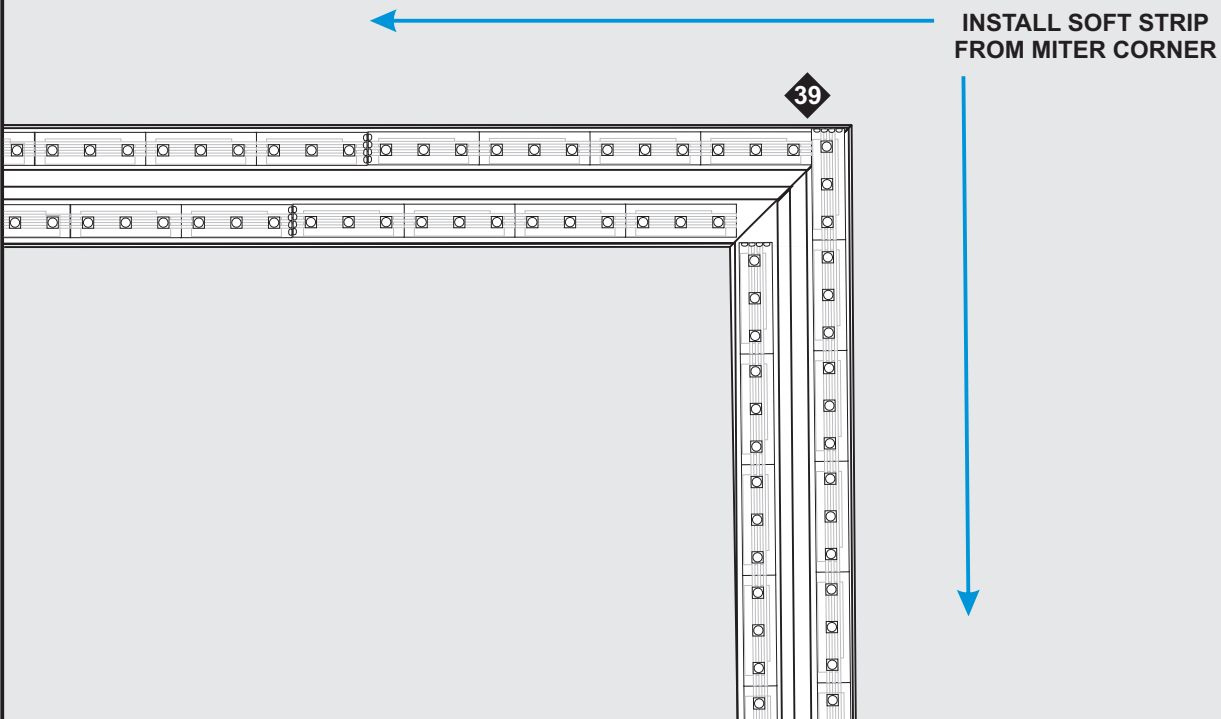

NOTE: Carefully measure the Soft Strip going inside the channel from the miter cut point toward the electrical boxes. Make sure the strip is no more than 2.4" longer than the channel section. Cut the Soft Strip at the marked cut points only. Refer to Soft Strip installation instructions for more details.

39: Carefully remove the backing from the LED soft strip, making sure not to remove the adhesive tape. Starting from the miter cut corner, firmly press down the end of the adhesive portion of the soft strip onto the channel surface while removing the rest of the backing, making sure there are no air bubbles that can cause surface irregularities.

Z5

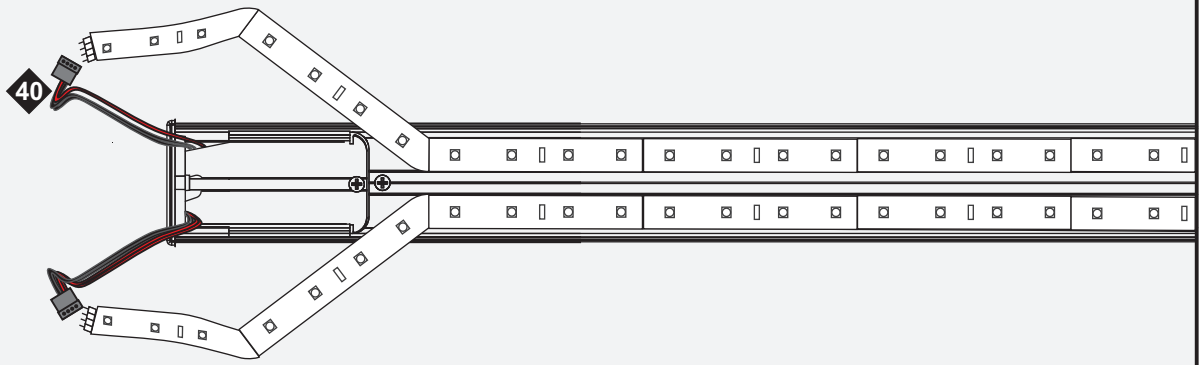

40: Line up the red wire side of the power connector with the “+24VDC” marking on the Soft Strip. Push the male connector of the Soft Strip into the female connector of the power cables.

41: Insert the power connectors and the excess soft strip into the junction box. Ensure the soft strip is adhered to the channel.

42: Repeat steps 39 through 41 to the other side of the channel.

Z6

CORRECT

52

NOT INSTALLED
CORRECTLY



43: Snap the lens back onto the channel.

44: If necessary, carefully fill the seam between miter cut section with clear silicone to prevent any light leaks.

Section Three: Installation With Uneven Studs

Z7



1: Mark the wall where channel mounting holes are located along the channel opening.

Z8



2: Cut 1" thick by 3" long sections of 2x4 to use as support bars.

3: Place the cut support bars through and behind the drywall at the marked mounting hole location.

4: Secure the support bars through drywall using two #6 drywall screws. Continue the installation as per Section One, Step 15.

GENERAL WIRING DIAGRAM

