



Compatible System Connectors



FJ-HAR-5-GO-SN
Fast Jack Harley with
Gobo Holder in Satin Nickel



FJ-HAR-5-GO-PN
Fast Jack Harley with
Gobo Holder in Polished Nickel



ST16-SN
Snoot Included

Description:

Harley with Gobo Holder projects a standard or custom gobo image on any surface. The focused light, from a halogen or **LED** 12VAC MR16 lamp, is shaped and magnified through the gobo holder and two convex lenses giving 25 degree beam spread - add third convex lens for 37 degree beam spread. Fixture rotates 360°, tilts 180°. For additional optical accessories, refer to Harley spec sheet.

System Compatibility:

Monorail (M) or Monorail 2 Circuit (M2) Use Fast Jack (FJ) version for FJ canopies

Height:

4.72" (12cm)

Finish:

Satin Nickel or Polished Nickel

Lamp Specification:

Maximum 75 watt MR16 lamp GU 5.3 base - 12 or 24 volt
LED MR16-12VAC compatible (sold separately)

Weight:

1.69 lb (.38 kg)

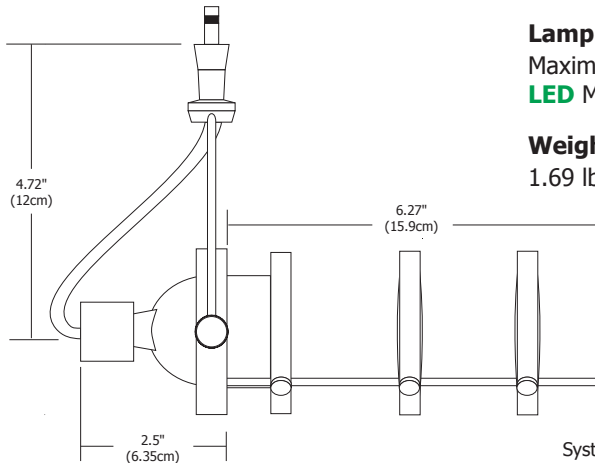

System	Fixture	Height	Accessory	Finish
FJ	HAR	5	GO	SN
FJ Fast Jack M Monorail M2 Monorail 2 Circuit	HAR Harley	5 4.7" (12cm)	GO Gobo Holder	SN Satin Nickel PN Polished Nickel

PROJECT: _____ FIXTURE TYPE: _____ DATE: _____